



GLENOWELL CZ s.r.o.
Na Truhlářce 2000/33, CZ – 180 00 Praha 8
Tel/Fax: **00420 775 256 912**
e-mail: info@glenowell.cz
www.glenowell.cz

SERVICE INSTRUCTIONS

Conveyer

GLENOWELL CZ s.r.o.
Na Truhlářce 2000/33
CZ – 180 00 Praha 8



Dear customer,

a conveyer belt with its light construction is determined for light operations mainly for transporting of loose material and small products. It will find its use in industrial, agricultural and manufacturing plants. It can transport agricultural products, e.g. potatoes, grain, vegetables, etc.

Our conveyers agree with the valid regulations of work safety. If you would like to know more detailed information about our products, please contact our purchase department at the address below:

GLENOWELL CZ s.r.o.
Na Truhlářce 2000/33
CZ – 180 00 Praha 8

Tel: 00420 775 256 912

1. General information

The construction of the conveyer sources from the long term experience and attestations in the plants.

Materials used for production are with the certified quality and they agree with the specification of production documentation. Each product is made and tested along with the approved technical documentation.

Each user and operating staff is obliged to read the service instruction carefully before operating the machine. The service instructions contain important information about the safety of work, assembly, operation, maintenance and it is essential to consider the service instructions as a part of the equipment. Failure-free and safe work with the machine and its operating life is to a great extent dependent on its right and careful maintenance.

If you find any information in the service instruction that is not clear, please contact the producer of the machine. We recommend you to make a copy of this manual after filling the data about the machine purchase and keep the original somewhere safe in case of loss or damage of the copy.

Follow the safety regulations during the operation to avoid the danger of injury of the operating person or persons around. These instructions in the manual are designated with the following sign:



When you see this sign in the manual, read the information carefully.

1.1 Safety regulations

Read and follow the safety regulation in the manual before assembling and operating the machine.



Qualification and training of the staff

The staff responsible for operating, maintenance and installation of the conveyer has to prove the required qualification. The range of responsibilities, cognizance and supervision of the staff has to be exactly specified by the operator regulation. If the staff does not have the required knowledge and skills, it is necessary to train and teach them. This is possible to arrange, if necessary, either with the manufacturer or the distributor.



The danger occurs by breaking the safety regulations

Breaking the safety regulations can lead to injury of staff or to the damage of the machine. This can lead to the loss of claims for any compensation of damage.



Safety regulations for servicing and assembling operations

The operator has to regard that all maintenance and assembling operations are performed by the authorized and qualified skilled staff which read the service instructions carefully. All servicing and assembling operations are performed in off mode of the machine. The way how to switch the machine off is shown in the manual and it has to be implicitly followed



Self willed rebuilding and spare parts manufacturing

The rebuilding or change of electro installation/machine can be performed only with the approval of the manufacturer. The original spare parts and authorized accessories by the manufacturer provide safety. Using other parts than approved cancels the possibility of guaranty for possible consequences.



Illegal way of operation

The safety of operation of the given machine can be assured only when it is used along with the paragraph 1.1 of these service instructions.



The sign of safety at work

You can find this symbol in the manual at the instructions dealing with the safety at work and at the instruction where there is a possibility of danger of life of persons. Follow these instructions and act very carefully. Also forward all regulations of safety at work to all other users.



Caution! High voltage!

This symbol is used at all places where it is necessary to keep attention because of the high voltage and where it is necessary to obey the safety regulations. It is necessary to unplug the machine from the electric network during the maintenance or servicing of the machine.

**Sign: Attention!**

This sign is at all places of this service instructions which are especially needed to note in order to keep all regulations, orders and a correct operation run; and also to avoid the damage of the machine.

1.2 Safety regulations

- all maintenance work and repairs on the conveyer, as well as the change of place by turning or shifting can be performed only in the off mode (unplug the machine)
- the transport of the conveyer can be done only in the low position
- entering or crossing over the conveyer belt during the operation is forbidden
- all protecting, or safety facilities used for maintenance, cleaning or repairing the conveyer has to be taken off after finishing these maintenance work.
- during the shifting and turning have in mind the electric wiring
- during the shifting, turning and operation nobody can hang or sit on the conveyer

The regulations of safety at work of the conveyer will be worked out at the operator. It will specify the possible risks for further negotiation on safety at work.

2. Main technical data

Designation Type	Conveyer						
	DP						
Width of belt (mm)	300	400	500	650	800	1000	1200 1600
Length of conveyer (m)	2-32	2-70	2-70	2-62	2-24	4-30	4-30
Output of the conveyer (t.hour ⁻¹)	18	22	30	40	60	60	60
Power input (kW)	0,75-2,2	0,75-8,0	0,75-8,0	0,75-8,0	0,75-8,0	0,75-8,0	0,75-8,0
Bevel of the conveyer	Smooth belt max. 20 % Rake belt max.50 %						
Speed of the belt	Standard 0,8 m.s ⁻¹ Optional power drive according the type up to 1,6 m.s ⁻¹						
Voltage of the electric network	See the instruction to the gear box						
Form of protection	See the instruction to the gear box						

3. Use

The machine is used along with the service instructions mainly for the transport of lump and loose material. To operate the machine correctly you have to follow the working, maintenance and installation regulations given by the manufacturer.

The machine can be used, maintained and set to operation only by persons who are qualified for it and know possible dangerous situations. Never perform any self willed changes. In other case the warranty of possible damage is canceled.

Construction changes within the technological development without the change of meaning of the manual are stipulated.



Important safety regulations

All applicable safety regulations have to be obeyed during the setting to the operation, maintenance and checking the controllers/machine. The abidance by rules is applicable for the operator, too.



Safety regulations for the operator/operating staff

- Do not touch the moving parts of the conveyer
- Avoid the danger of injury by the electric current

4. Installation

Installation can be done only by persons who are qualified for it and know possible dangerous situations. Never perform any self willed changes. In other case the warranty of possible damage is canceled.

Construction changes within the technological development without the change of meaning of the manual are stipulated.

Do installation according to next Installation guide. Keep operational, maintenance and install conditions determined by producer.

4.1 Installation guide

1. Bolt section together
2. Placing of a tighten head
3. Detail of tighten
4. Placing of a draught head
5. Drive detail
6. Bottom roller
7. Outside wiper
8. Detail of a wiper
9. Barrier + block

10. Detail of a block
11. Hopper + barrier
12. Detail of hopper
13. Hopper for empty
14. Detail of hopper for empty
15. Roof + bottom covering
16. Detail of a roof
17. Support
18. Detail of a support
19. Complet conveyoyr

4.2 Picture enclosure to installation

1. Bolt section together

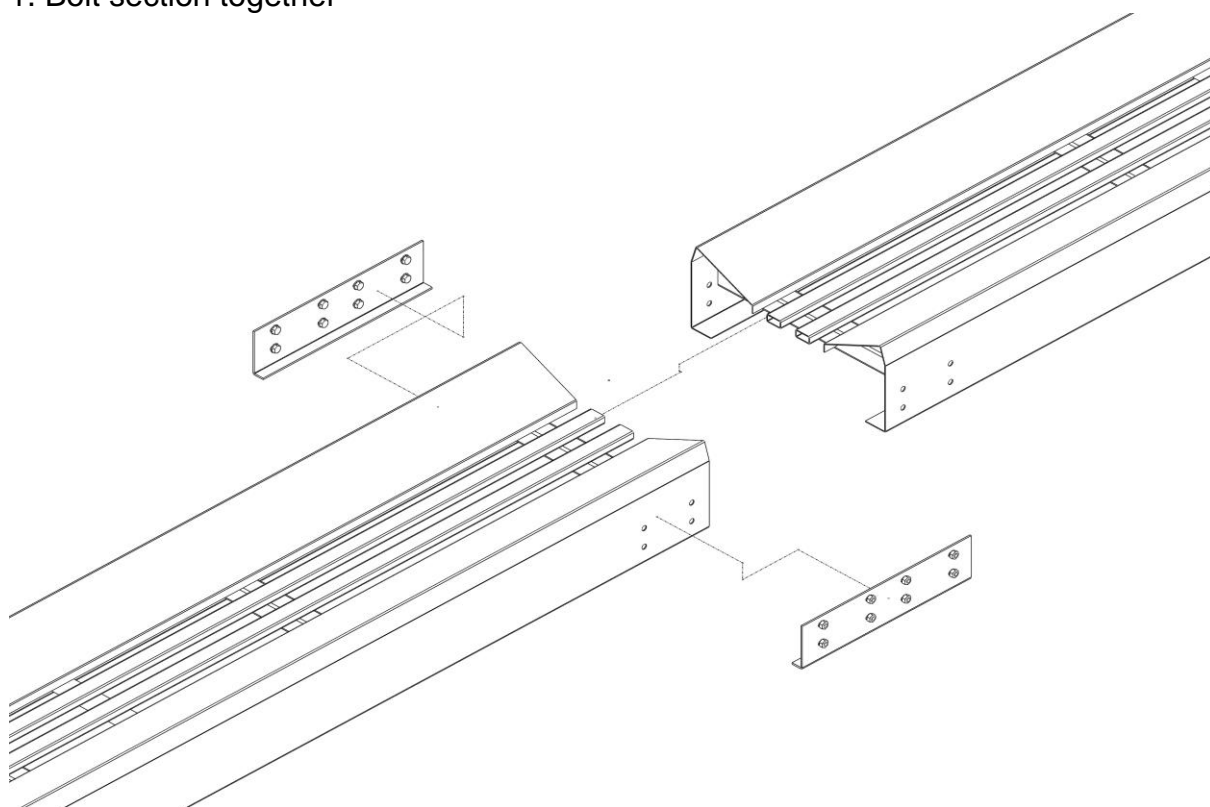

2. Placing of a tighten head

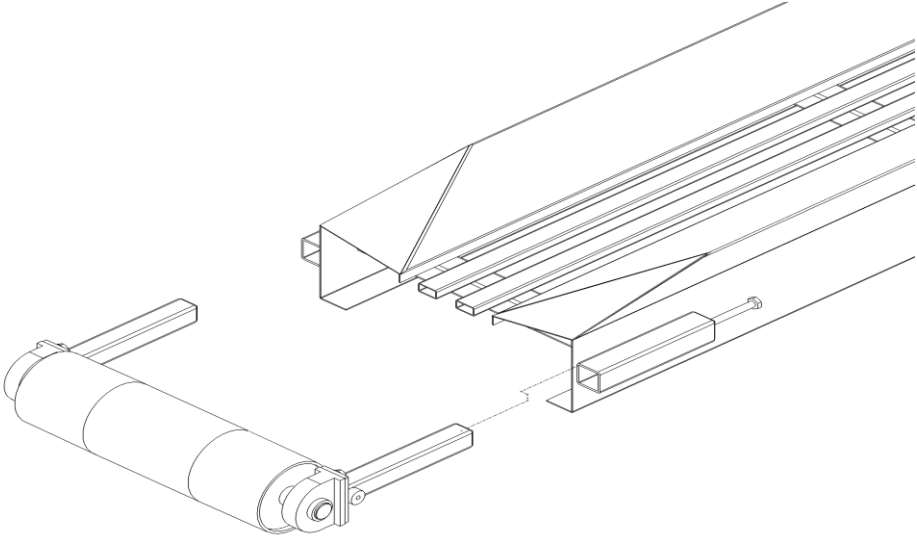

3. Detail of tighten

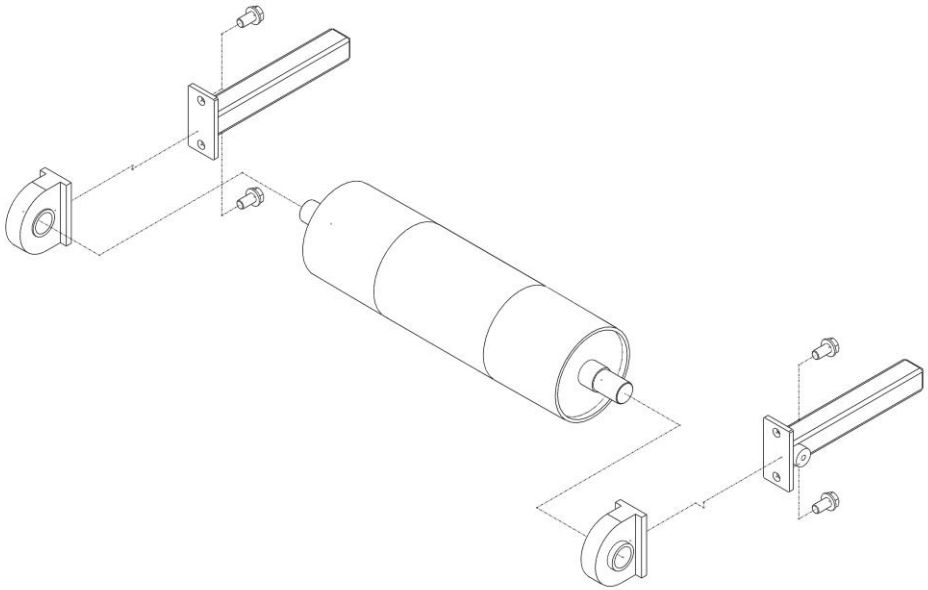

4. Placing of a draught head

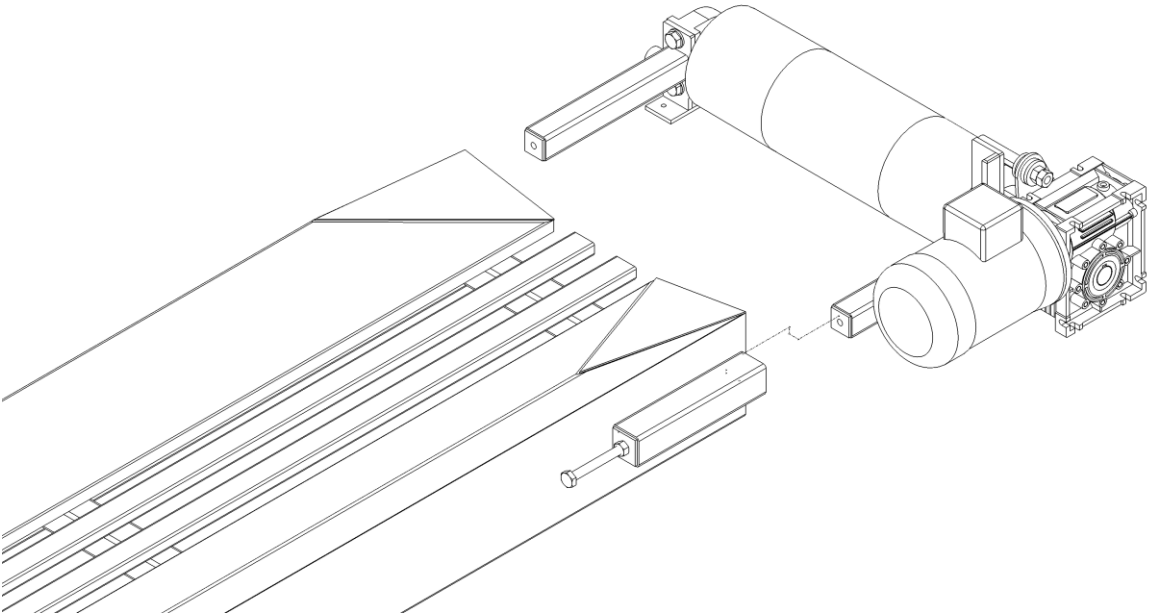

5. Drive detail

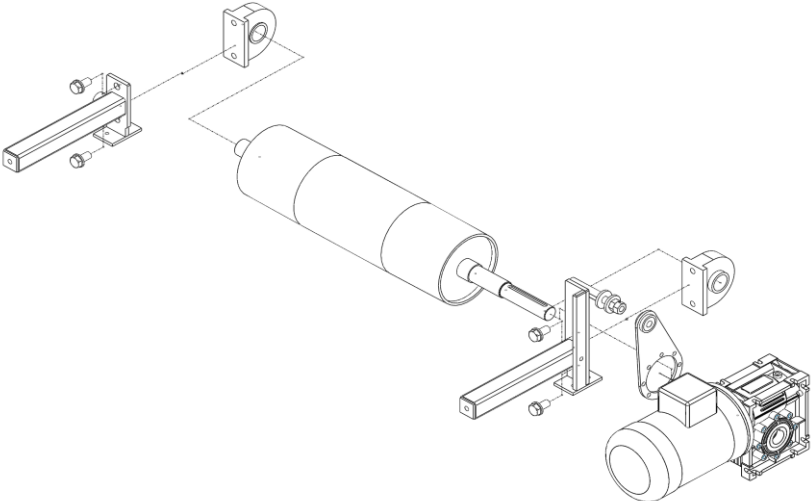

6. Bottom roller

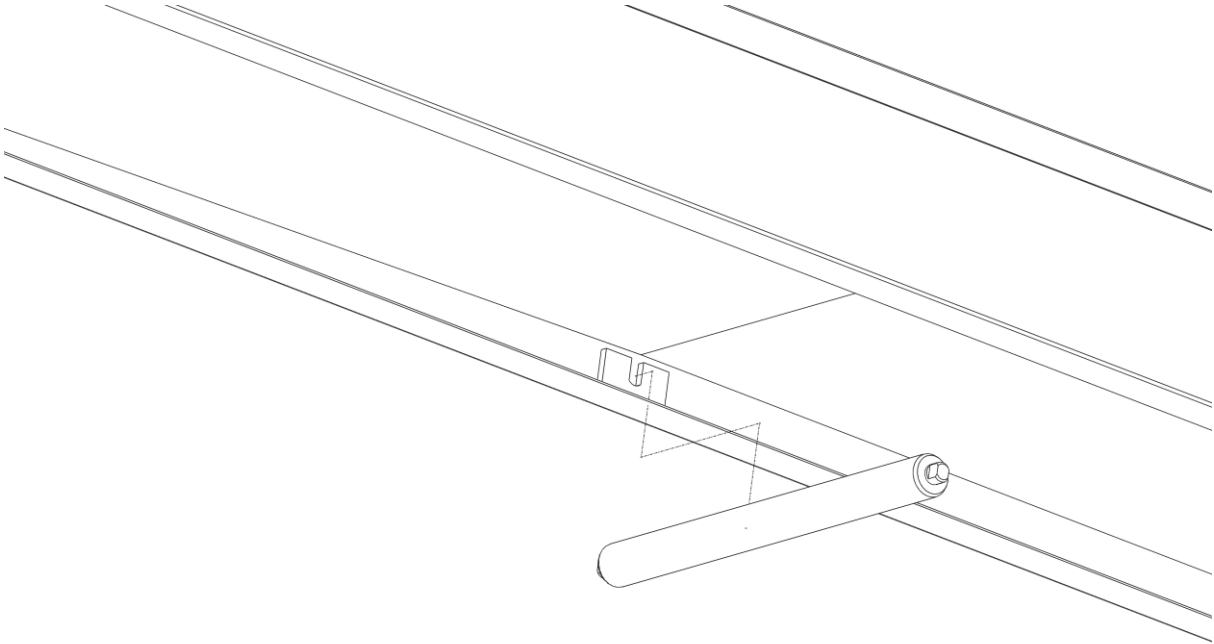

7. Outside wiper

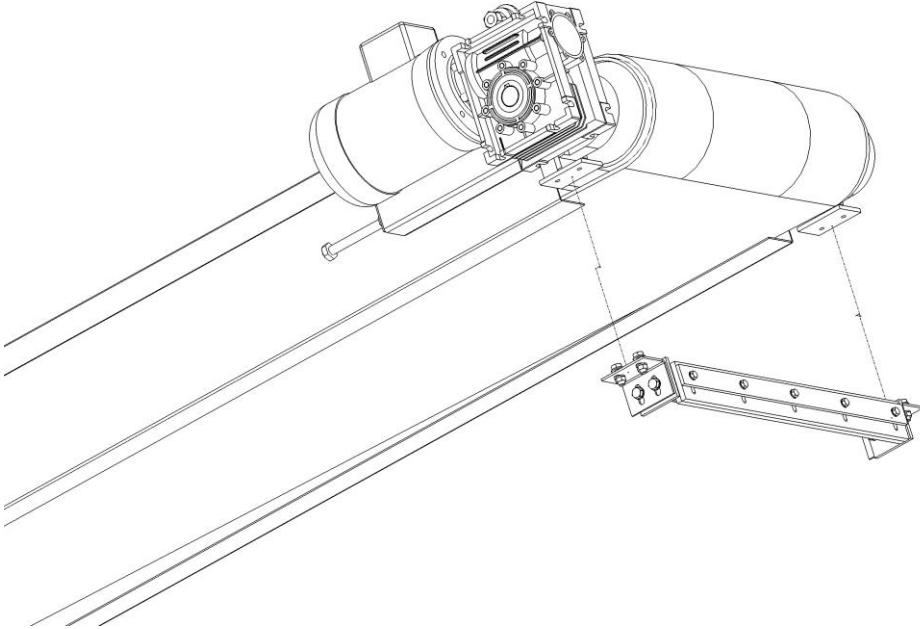

8. Detail of a wiper

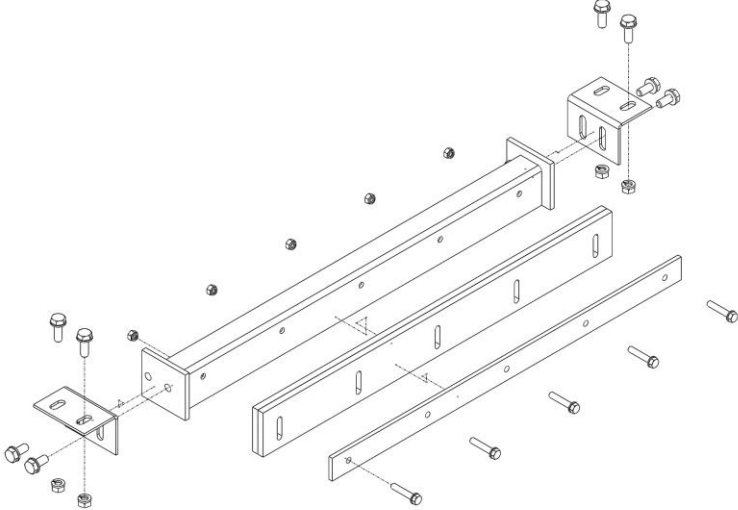

9. Barrier + block

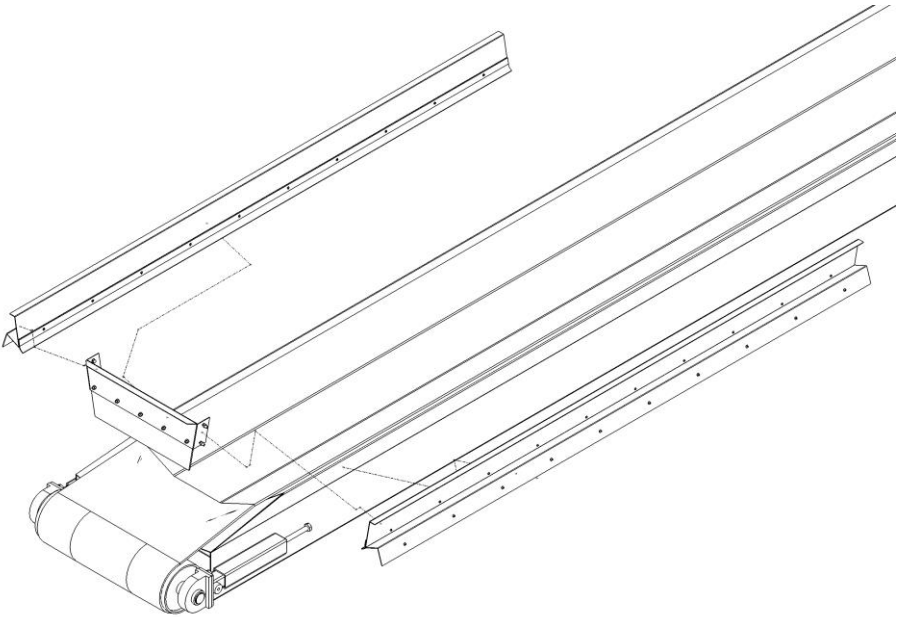

10. Detail of a block

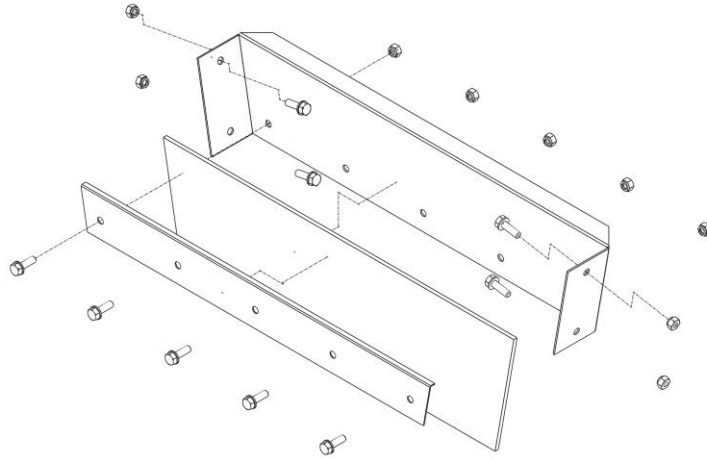

11. Hopper + barrier

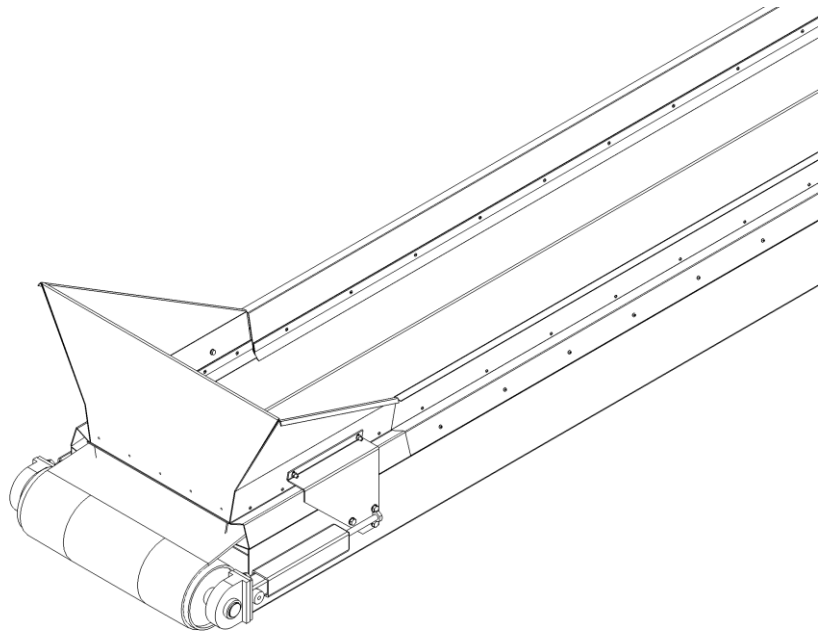

12. Detail of hopper

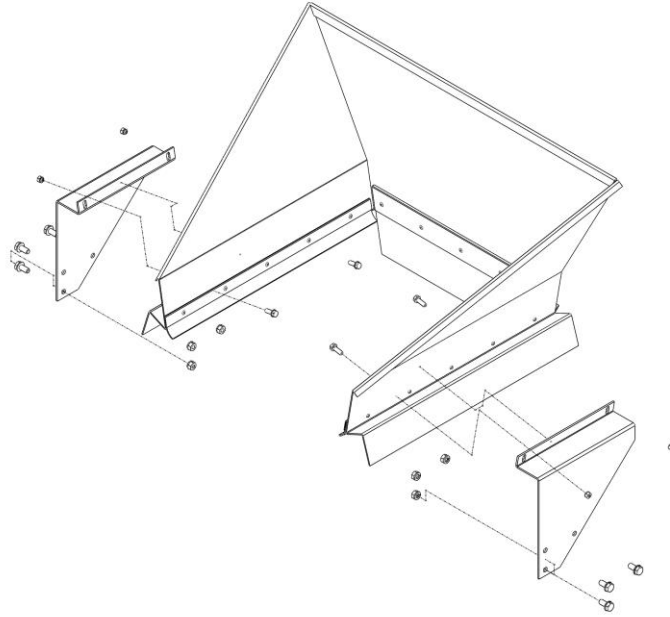

13. Hopper for empty

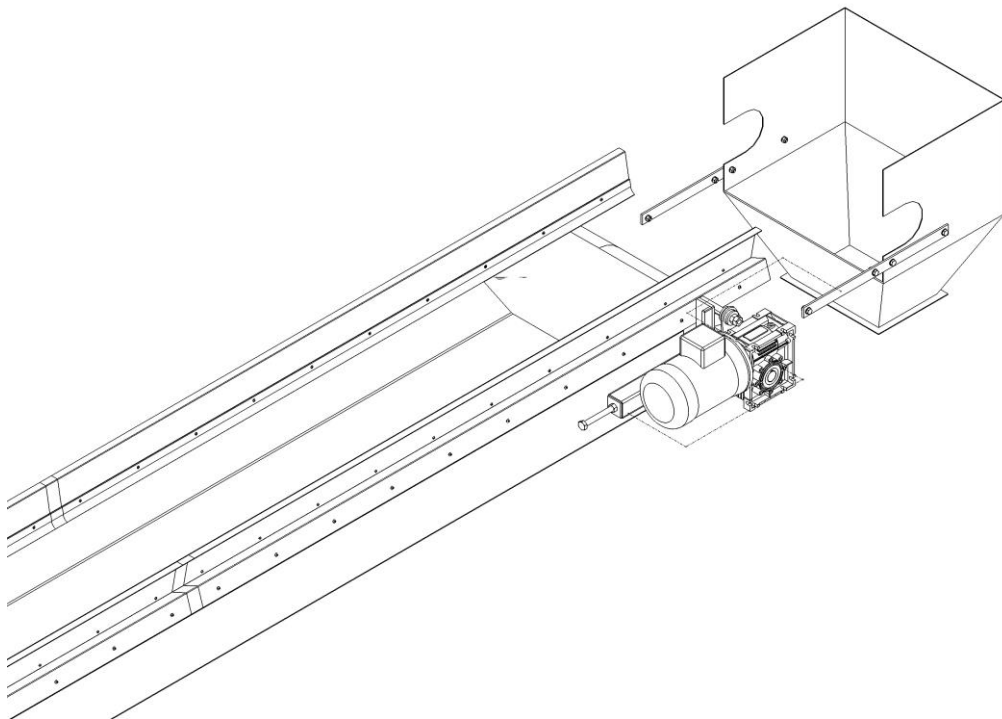

14. Detail of hopper for empty

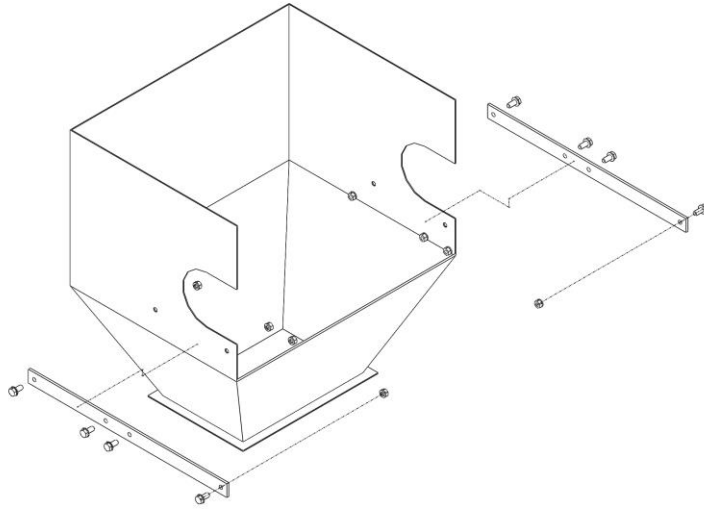

15. Roof + bottom covering

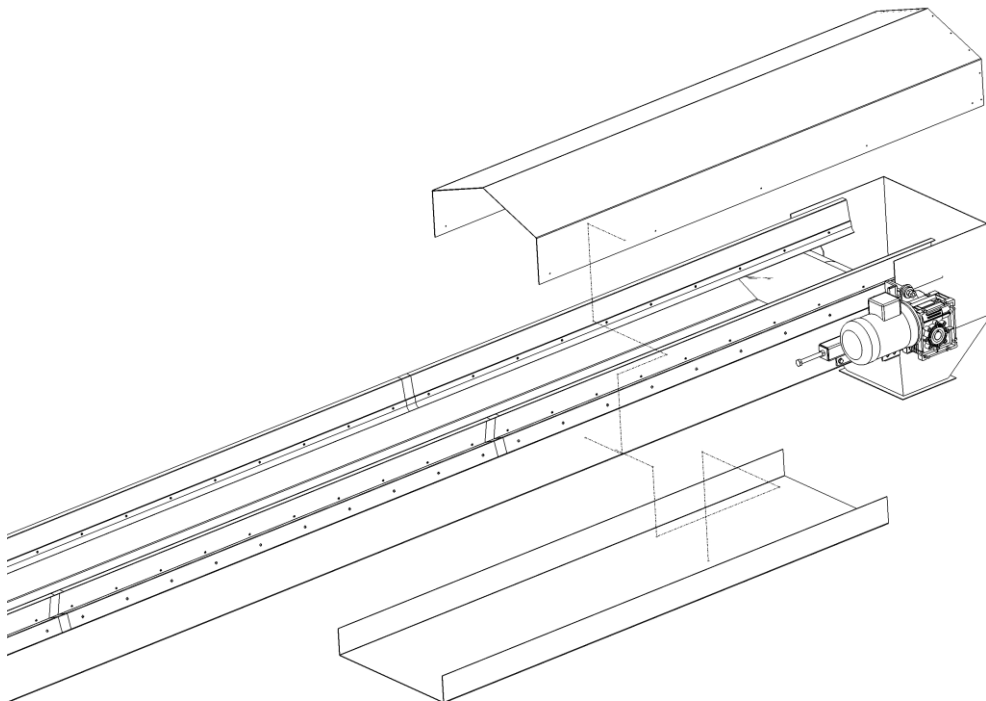

16. Detail of a roof

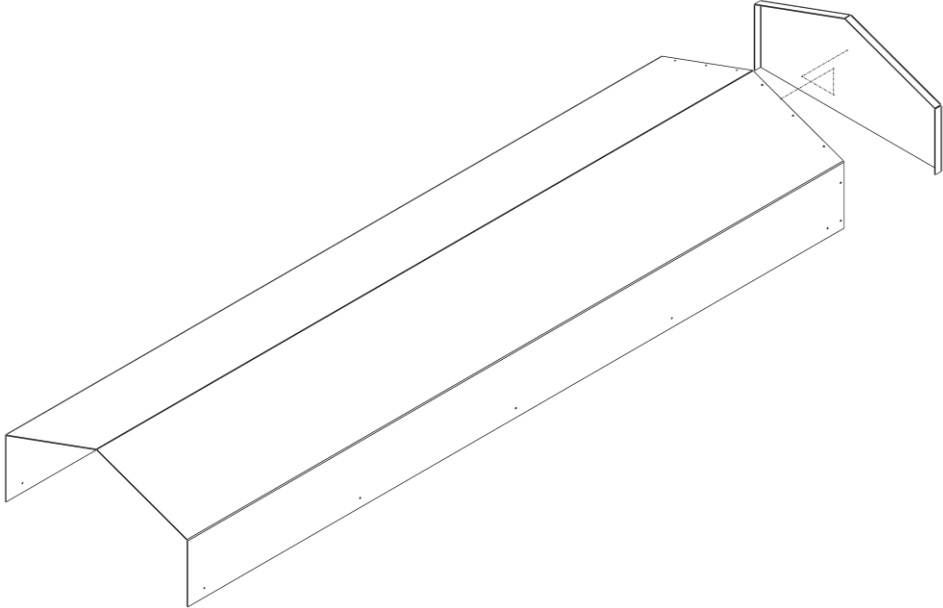

17. Support

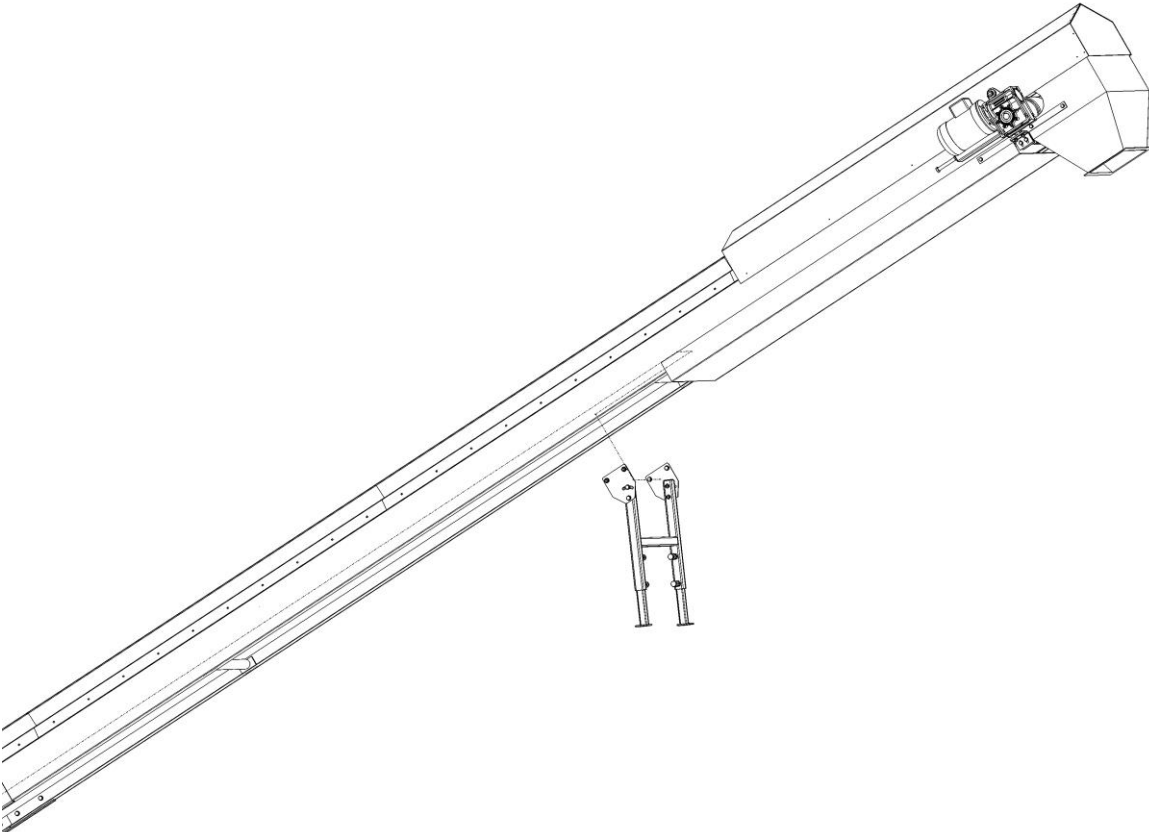

18. Detail of a support

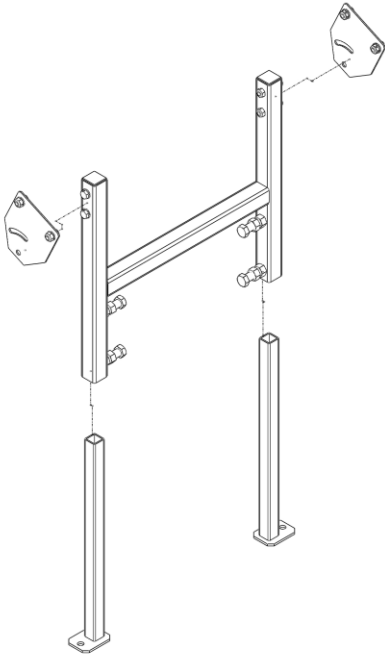

19. Complet conveyor

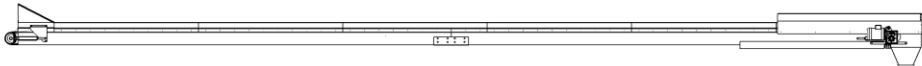

9. Starting up

It is needed to build the conveyer on the solid surface. It has to be fastened down. For the stationary conveyer it is necessary to ensure the electric plug in by the specialist. The belt has to be tightened up correctly. After the switching on the conveyer it is necessary to check the direction of run, belt tension, action of the belt and adjust this.

The polygonal conveyers it is necessary to check the movement at the point of break and the depression rollers. The direction of movement of the belt can be changed by changing the phase or by reversing the polarity.

The above mentioned has to be provide by the specialist. For the mobile conveyers it is necessary to fix the suspension before the conveyer's operation, or according possibilities to put the suspension aside. When built again, or changing the position, the peg gudgeons have to be fixed again with the safety bolts. For the conveyers with the frequency control follow the service instructions for the frequency alternator.

During the handling and starting up it is necessary to follow the service instructions given by the manufacturer or sub-supplier.

The operator will provide documentation of starting up process, and the documentation of maintenance according the requests of the manufacturer or sub-supplier.

10. Maintenance

Attention! In case of any maintenance, servicing or repairs unplug the machine from the power supply. (Pull out the plug from the electric network).

For the new conveyers it is necessary to perform the following work after 20 hours of operation:

- Check if all screws are fastened tightly, eventually tighten them.
- All ball bearings are self lubricant and therefore they are maintenance free.
- For the gear drive it is necessary to follow the maintenance regulations specified by the manufacturer of the engine.
- Check the run and belt tension, and if necessary, adjust it or tighten.
- For the conveyers with chassis, the pulley-block, the safety knob and eccentric have to be without oil or vaseline
- For the polygonal conveyers it is necessary to check the run of the belt in the break and eventually adjust it with the pressure roller

11. The drive with the socket gearbox

The drives of this kind are mainly maintenance free. It is necessary to follow the given instructions for the placing, operating and maintenance.

**AFTER FINISHING OF ALL WORK IT IS NECESSARY TO CHECK AND
TIGHTEN ALL LOOSE SCREWS**

12. Adjusting of the belt

The conveyer belt can be adjusted only during the run of the conveyer. At first it should be adjusted unloaded. After adjusting it is necessary to tighten all loose screws and female screws.

13. Conditions of guarantee

The manufacturer provides a guarantee for the machine for the length of six months since the date when it is put into operation, but maximally for the length of 12 month from the delivery if it is not stipulated in other way.

If the product is not used along with its specification, this can be a reason for canceling the conditions of guarantee.

The guarantee is attended by the supplier:

GLENOWELL CZ s.r.o.
 Na Truhlářce 2000/33
 CZ – 180 00 Praha 8
 Tel.: 00420 775 256 912

14. Possible problems, reasons and their elimination

Problem	Reason	Elimination
Down-slipping of the belt	Unbalanced extending of the belt	Adjust the start of the belt at the pull and tension head
Unusual noise coming from the gear-box	a) foreign matter in the oil b) faulty bearing c) damaged gearing	a) change the oil b) service c) service
The oil is coming from the gear-box	a) faulty packing b) the gear-box is not deaerated c) too much oil	a) service b) deaerate the gear-box c) adjust the amount of oil
Gear-box drive shaft is not turning, although the engine is running	The connection of the shaft hub was disconnected	service
The conveyer stopped	a) loose belt b) overloading of the conveyer (the motor circuit protector jumped out)	a) adjust the tension of the belt b) do not overload the conveyer, lower the height of the material/output

15. Spare parts

When ordering the spare parts, please indicate:

- **Serial number**
- Type of product
- Specification of the product: width, length, engine, type of belt
- Contract number
- Date of delivery
- Required spare part

16. Applied safety pictograms

Caution:

The user is obliged to keep the pictograms in readable condition and in case of their damage provide the exchange!

Place the pictograms after assembly on the machine and to such places which are visible from access ways.

Applied pictograms and their meaning

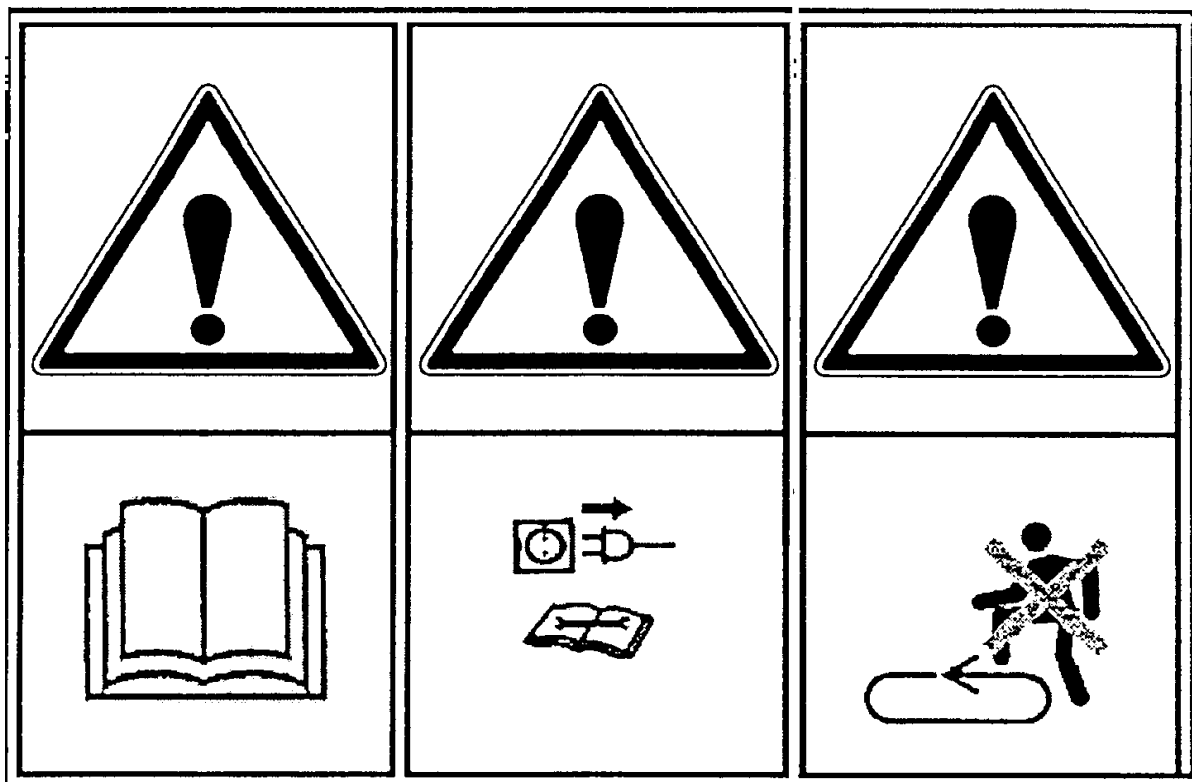

Read the instructions before the use	Switch off the machine before repairing, servicing or maintenance and follow the instructions	Keep off the moving parts of the machine
--------------------------------------	---	--